

KEEP GROWING DETROIT



CULTIVATING A FOOD SOVEREIGN CITY WHERE THE MAJORITY OF FRUITS AND VEGETABLES CONSUMED BY DETROITERS ARE PRODUCED BY RESIDENTS WITHIN THE CITY LIMITS

DETROIT GARDENS & FARMS, 2022

GARDEN RESOURCE PROGRAM

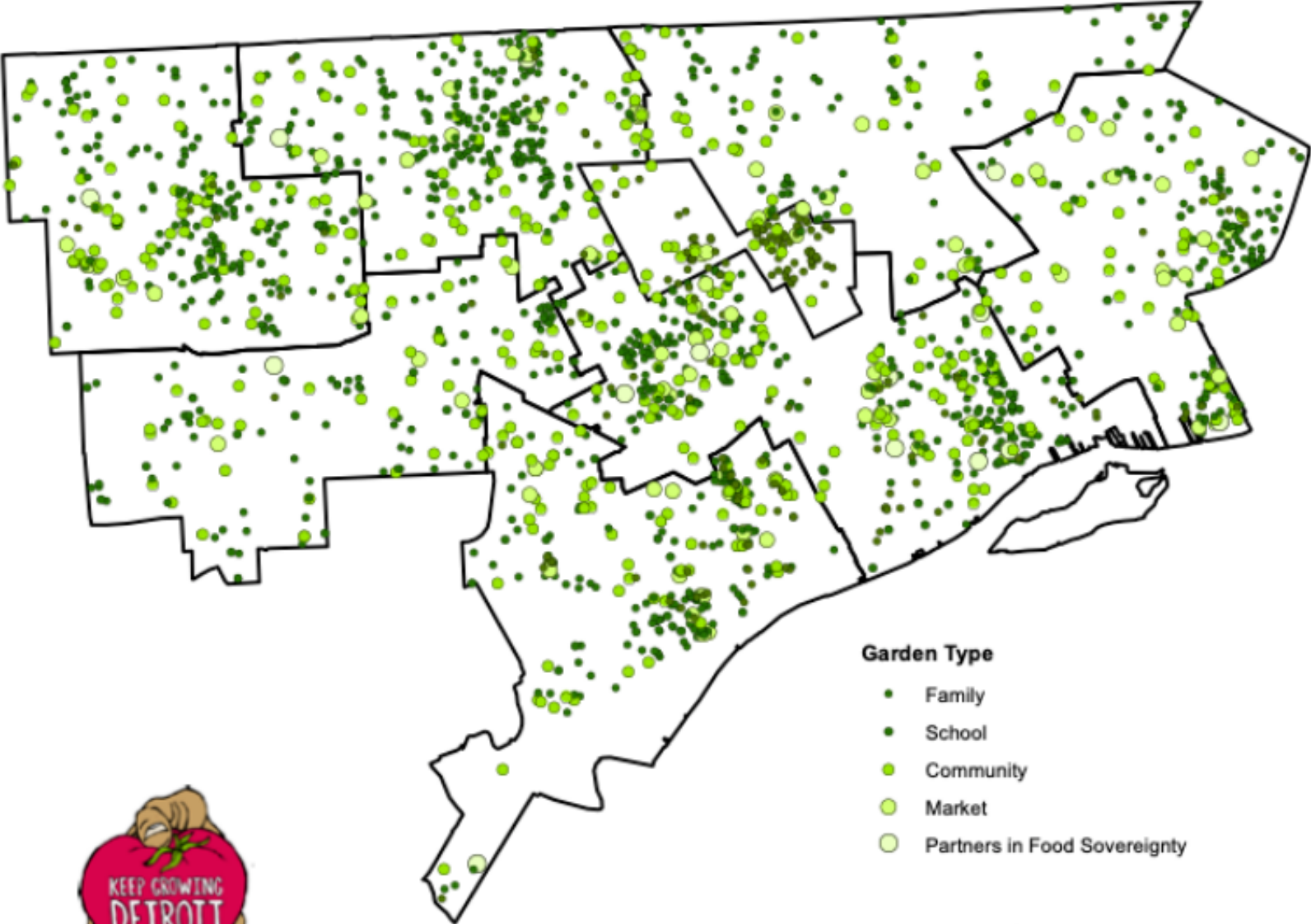

Garden Type

- Family
- School
- Community
- Market
- Partners in Food Sovereignty





Family Gardens



Community Gardens



School Gardens



Market Gardens



RESOURCES FOR GROWERS



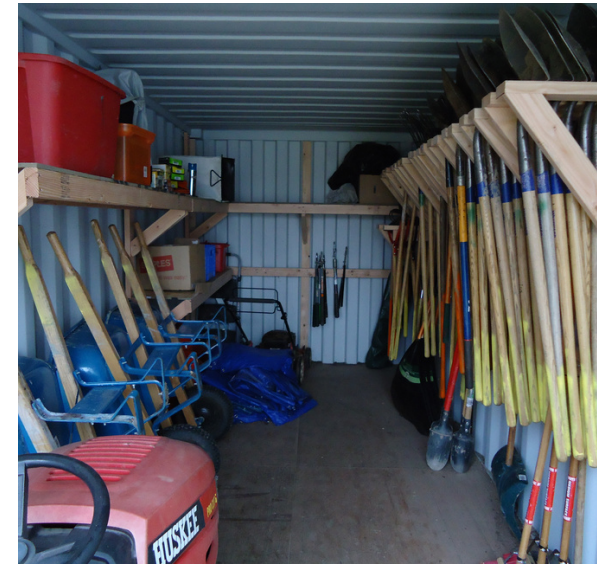
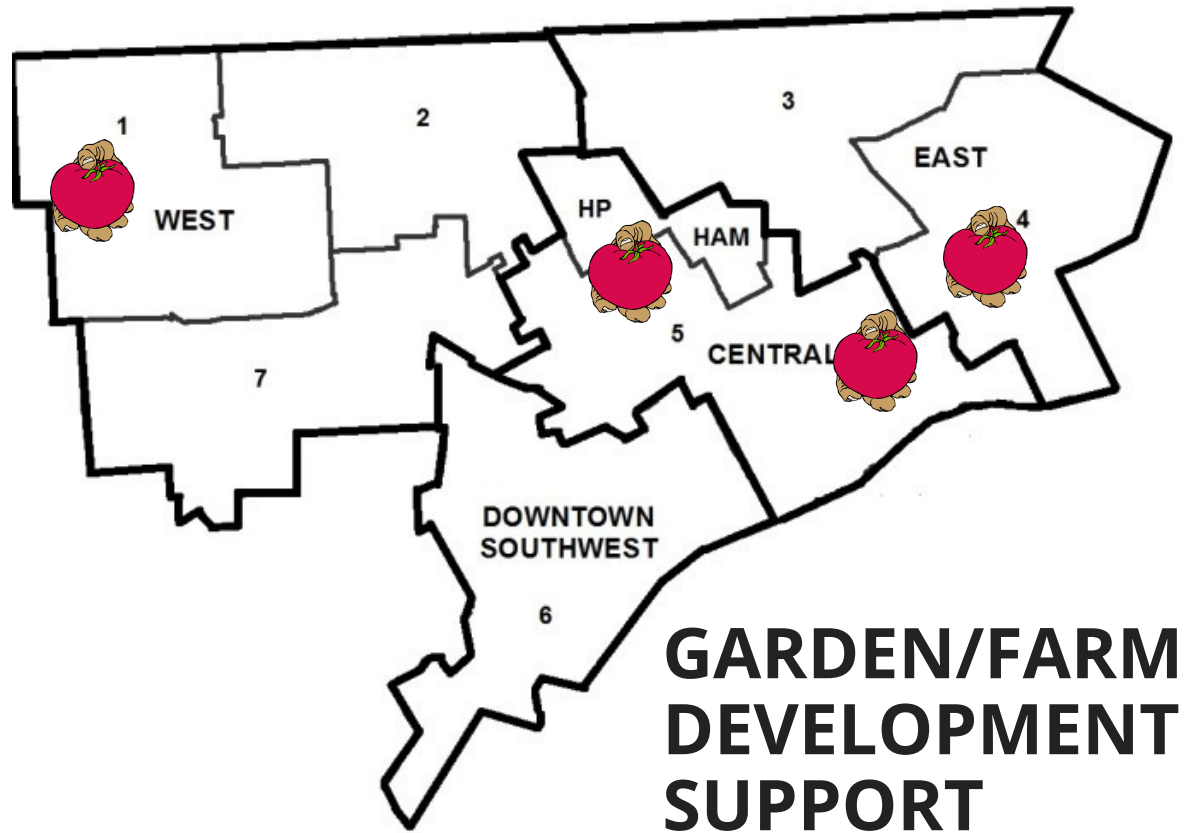



PLAN YOUR GARDEN! 2017 GARDEN RESOURCE PROGRAM SEED & PLANT VARIETIES

For choices, F=Family Garden, S=School Garden,
C=Community Garden, M=Market Garden

SPRING SEEDS

CHOICE 1 (F: choose 2, S/C/M: choose 6)
• All Greens Mix (GRP Mix)
• Turnip (Purple Top White Globe)
• Arugula (Astro)
• Swiss Chard (Bright Lights)
• Mustard (Southern Giant Curled)

CHOICE 2 (F: choose 2, S/C/M: choose 6)
• Snap Pea (Sugar Sprint)
• Shelling Pea (Premium)
• Collards (Champion)
• Broccoli (Rash)

ALL GARDENS THAT JOIN BEFORE FALL CR RECEIVE A WELCOME SEED PACK

- F: 6 packs, S/C/M: 18 packs
- Carrots (Scarlet Nantes)
- Cilantro (Calypso)*
- Spinach (Space)
- Lettuce Mix (GRP Mix)
- Radishes (Easter Egg)
- Slicing Cucumbers

HOT CROP TRANSPLANTS & SEEDS

- Seeds
- CHOICE 1 (F: choose 2, S/C/M: choose 6)
- Bush Bean (Provider)
 - Pole Bean (Kentucky Wonder)
 - Blackeye Pea (California)
 - Yard Long Bean (Red Noodle)*
 - Edamame (Midori Giant)*
- CHOICE 2 (F: choose 2, S/C/M: choose 6)



CLASSES & WORKSHOPS



GROWING RELATIONSHIPS





2020 + 2021 DETROIT BLACK FARMER LAND FUND AWARDEES

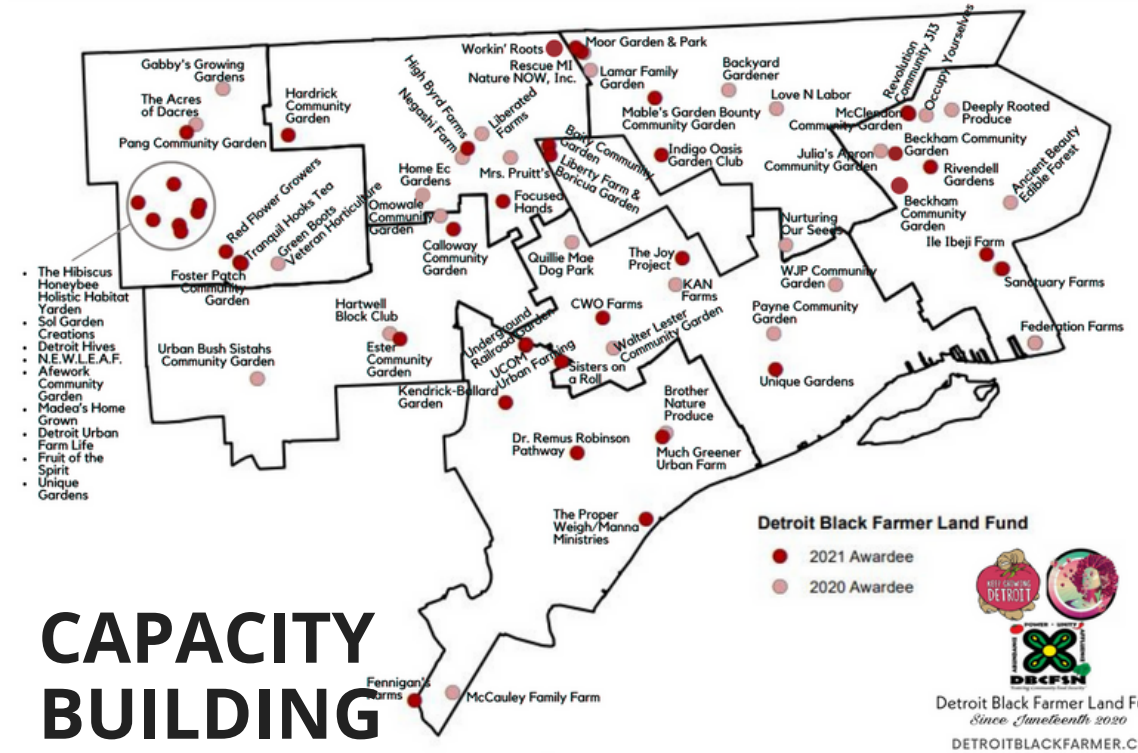

CAPACITY BUILDING

Plot Plan, Site Design, and Maintenance Guide

Plot Plan Example #3

"Quilted Farm, LLC"
 5678 Ninth Street
 Detroit, MI 48234

- Draw your site:**
 - Property lines
 - Sidewalks along edge of property
 - Required setbacks for plantings, structures, and other items from the property line
- Draw all existing and proposed:**
 - Structures
 - Fences or other features
 - Driveways or other vehicle access locations
 - Water access
 - Rain catchment systems or rain gardens
 - Trees
 - Storage
 - Compost, brush and/or trash storage
 - Temporary restrooms and screening
 - Benches and sculptures or other art elements
 - Paths
- Draw in the areas where you will have:**
 - Row crops/planting areas
 - Raised beds
- Label all existing and/or proposed:**
 - Seed banking, permaculture techniques and pollinator habitat
 - Streets and alleys next to the property
 - Fences with heights and materials
 - Dimensions and area of

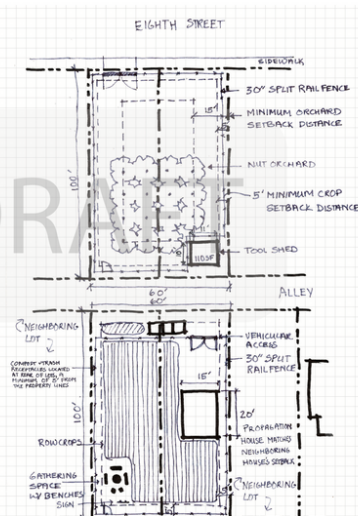

EXPANDING MARKETS





INFRASTRUCTURE PROJECTS





FOOD ECOSYSTEM WORK



23 DETROIT COMMUNITY MARKETS

WHO WE ARE
 Detroit Community Markets is a new neighborhood locations where you can affordable, locally grown and produced includes farmers markets, farm stands, a food box programs! Most of our locate Bridge Cards & Double Up Food E

DETROIT COMMUNITY MARKETS

DETROITMARKETS.ORG
 @detroitmarkets

Please check each website & social media for updates about hour pick-up, food boxes.

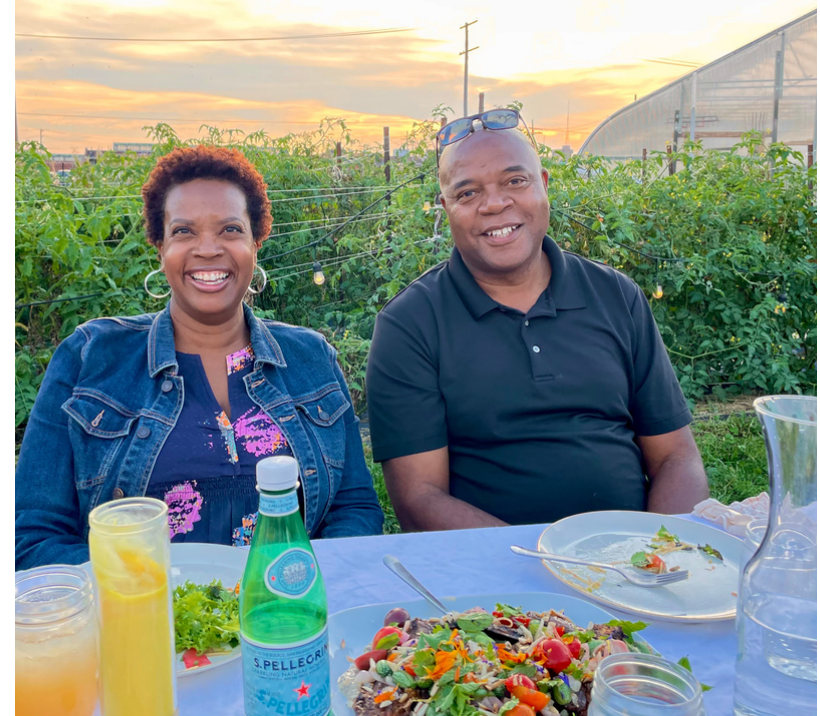

35% OF WORLD'S FOOD GROWN IN FARMS & GARDENS UNDER 5 ACRES

15% OF WORLD'S FOOD GROWN IN URBAN AREAS







www.keepgrowingdetroit.org

(313) 656-4769

 [keepgrowingdetroit](https://www.facebook.com/keepgrowingdetroit)

 [@keepgrowingdetroit](https://www.instagram.com/keepgrowingdetroit)